

SAVE THESE INSTRUCTIONS FOR FUTURE USE

- ⚠ **WARNING:** Important! Read and understand these instructions before installing or removing the Spreader Bar. If you do not understand any part of these warnings, cautions or instructions, contact a healthcare professional for direction in the use of this product. If the Spreader Bar is not properly installed, personal injury and damage to the Spreader Bar could result.
- ⚠ **WARNING:** If components are damaged or missing, contact your distributor immediately. **DO NOT** use substitute parts. Use only Everest & Jennings replacement parts. Non-Everest & Jennings replacement parts could cause personal injury and damage to the Spreader Bar.
- ⚠ **WARNING:** Cancer and Reproductive Harm - www.p65warnings.ca.gov.
- ⚠ **WARNING:** GF Health Products, Inc. assumes no responsibility for any damage or injury caused by improper assembly or use of this product.

SPREADER BAR REMOVAL (SEE PICTURES)

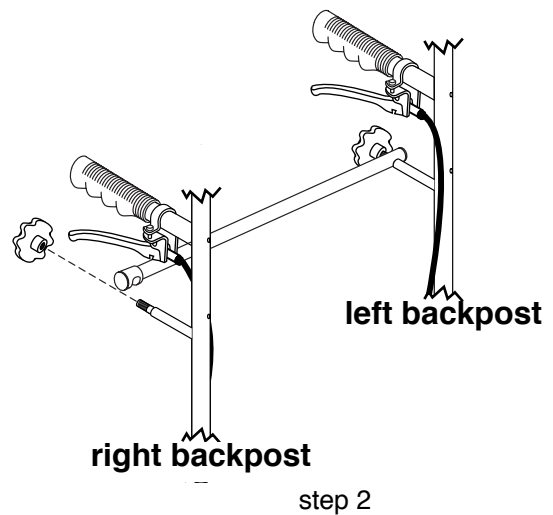
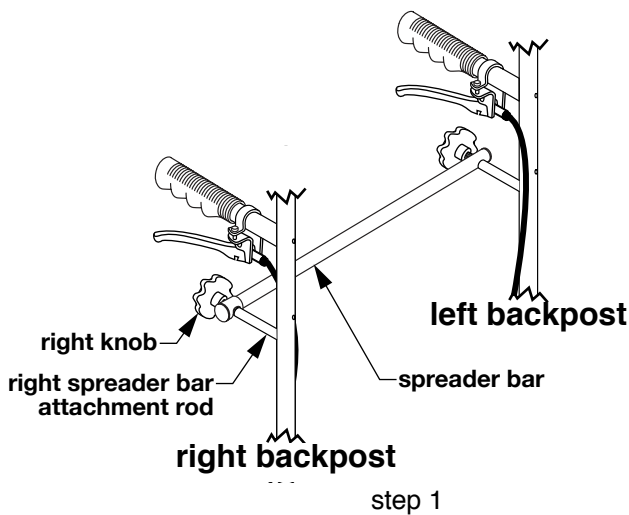

1. Unscrew knob from right spreader bar attachment rod as shown at above left; remove knob.
2. Lift spreader bar gently from right spreader bar attachment rod and pull it back a little, free of spreader bar, as shown at above right. Allow spreader bar to rotate and drop to the left.
3. Unscrew knob from left spreader bar attachment rod as shown at right; remove knob.
4. Pull off spreader bar from left spreader bar attachment rod as shown at right and detach it completely.

Info: Retain all components for future use.

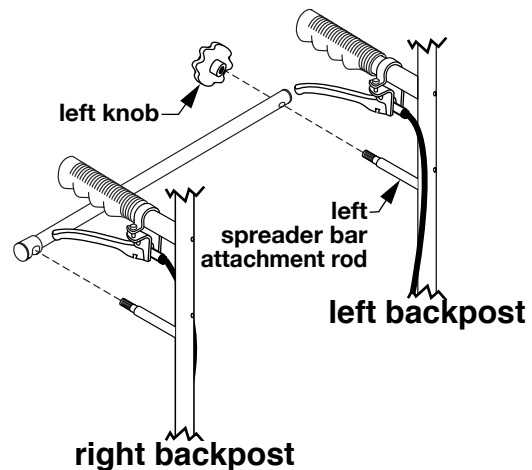

SPREADER BAR INSTALLATION (SEE PICTURES)

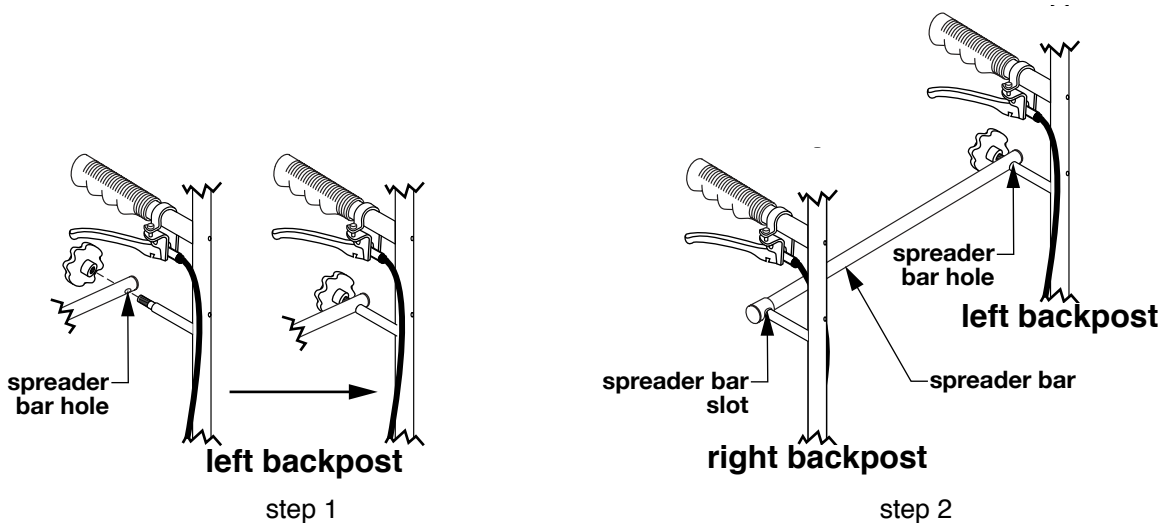

1. Install knob through spreader bar hole into left spreader bar attachment rod as shown at above left; screw in until secure.
2. Lift right end of spreader bar, position spreader bar slot over right spreader bar attachment rod, and push down gently to trap right spreader bar slot on right backpost spreader bar attachment rod as shown at above right.
3. Install knob through spreader bar slot into right spreader bar attachment rod as shown at right; screw in until secure, ensuring spreader bar is horizontal and right end of spreader bar is secure.

⚠ WARNING: Ensure Spreader Bar is securely installed, as described, before use.

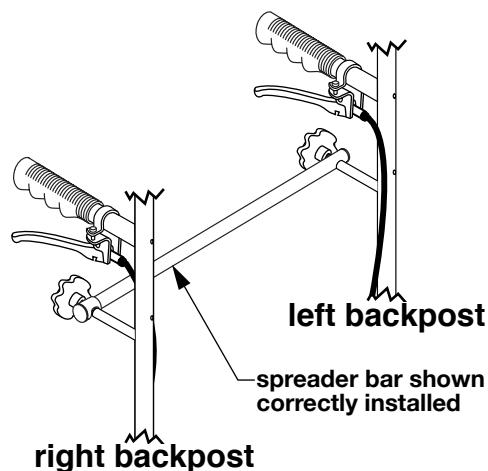

graham
field

1.770.368.4700

Information contained herein is subject to change.
The most current and complete product information can be found on our website.
www.grahamfield.com

Follow us on  

© 2019, GF Health Products, Inc. All Rights Reserved.
Everest & Jennings is a trademark of GF Health Products, Inc., One Graham-Field Way, Atlanta GA 30340-3140
GF Health Products, Inc. is an ISO 13485 Certified Company.