

SAFETY GUIDELINES - PLEASE READ BEFORE USE

- ⚠ **WARNING: Important: Read and understand these instructions before installing or servicing the Overbed Table. If the Overbed Table is not properly assembled and serviced, personal injury and damage to the Overbed Table could result.**
- ⚠ **WARNING: If components are damaged or missing, contact your Graham-Field authorized distributor immediately. DO NOT use substitute parts. Non-Lumex replacement parts could cause personal injury and damage to the Overbed Table.**
- ⚠ **WARNING: Table weight capacity:
The main surface supports up to 100 lb (45.4 kg) of dispersed weight, **EVENLY DISTRIBUTED**
The flip top supports up to 10 lb (4.5 kg) of dispersed weight, **EVENLY DISTRIBUTED.****
- ⚠ **WARNING: Cancer and Reproductive Harm - www.p65warnings.ca.gov.**
- ⚠ **WARNING: GF Health Products, Inc. assumes no responsibility for any damage or injury caused by improper assembly or service of this product. SERVICE PROCEDURES (FOLLOW STEPS *IN ORDER LISTED*; REFER TO ILLUSTRATION ON PREVIOUS PAGE; TOOLS REQUIRED ARE LISTED WITH EACH PROCEDURE)**

Required Tools: #3 Phillips Screwdriver

1. Turn “overbed table” upside down placing on a non-scratch surface.

- ⚠ **WARNING: To avoid personal injury or damage to the table, support the table top before removing the screws securing it to the top support.**

2. Remove six (6) screws holding hinge to flip top along with two (2) screws holding “lidstay” to outer column.
3. Remove six (6) bolts with washers that fasten top support bracket to main top.
Do so carefully as unit becomes less stable at this point.
4. Replace main top and re-fasten top support bracket to it using six (6) bolts with washers from Step 3 above.
5. Replace flip top (by reversing Step 2 above).
Do not use too much torque.
6. Turn table upright and check flip for smooth movement. If alignment adjustment is needed, gently loosen screws attaching “lidstay” to outer column and adjust bracket up or down and re-tighten. Do not use too much torque.

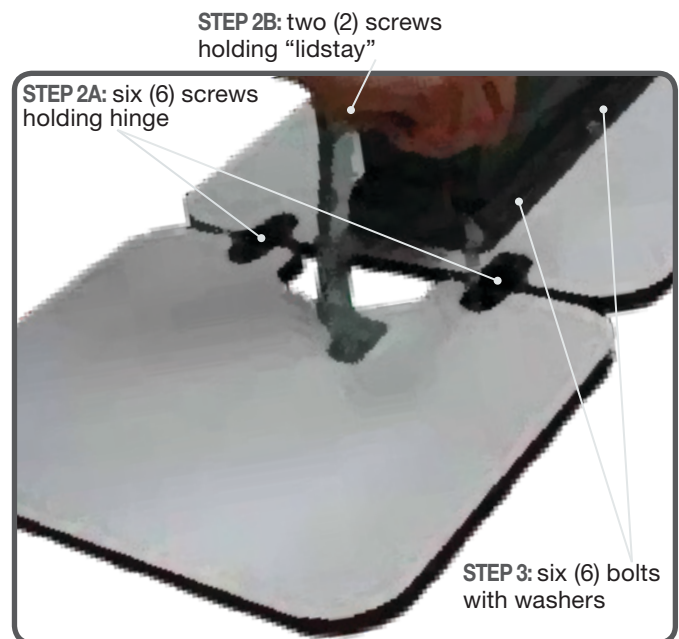

+1 770.368.4700

Information contained herein is subject to change without notice. The most current and complete product information can be found on our website www.grahamfield.com



Intertek

GF Health Products, Inc. is an ISO 13485:2016 MDSAP Certified Company



© 2020, GF Health Products, Inc. All Rights Reserved. Lumex is a registered trademark of GF Health Products, Inc.



grahamfield